

# Utility Gauge D80 Series



D83LFSS, 2 1/2" pictured

2", 2 1/2" & 4"  
Dial Sizes

±1.5%  
Accuracy

Stainless  
Steel Case

Glycerine  
Fill Standard

The Trerice Series D80 Utility Gauge is designed for rugged performance requirements at an economical cost. This liquid filled gauge is furnished with a stainless steel case and crimped ring. Wetted parts are either bronze tube with brass socket or stainless steel.

Optional features and case styles are also available. Please consult the Options Section for details.

For correct use and application of all pressure gauges, please refer to Pressure Gauge Standard ASME B40.100.

## Specifications

<b>Models</b> D82LFB (liquid filled) D83LFSS (liquid filled)	<b>Movement</b> D82LFB: Brass D83LFSS: 316 stainless steel	<b>Window</b> 2", 2 1/2" Dial Size: Styrene-acrylonitrile 4" Dial Size: Grilamid	<b>Accuracy</b> ±1.5% Full Scale
<b>Size</b> 2", 2 1/2", 4"	<b>Connection</b> Lower male or center back male, 1/4 NPT	<b>Pointer</b> Plain, black finish	<b>Maximum Temperature</b> 150°F (65°C)
<b>Wetted Parts</b> D82LFB: Bronze tube, brass socket D83LFSS: 316 stainless steel tube and socket	<b>Case</b> 304 stainless steel, stem mounted flangeless	<b>Dialface</b> Aluminum, white background with black graduations and markings	<b>Approximate Shipping Weight</b> 2" Dial Size: 0.4 lbs [0.18 kg] 2 1/2" Dial Size: 0.5 lbs [0.23 kg] 4" Dial Size: 1.0 lbs [0.45 kg]
	<b>Ring</b> Crimped 304 stainless steel		

## How to Order

Sample Order Number: D82LFBG25FSL250PSI110  
D80LFB G 25 FSL 250 PSI 110

Model	Liquid Fill Type	Dial Size	Case Type & Connection Location	Connection Size	Units of Measure	Range Code
D82LFB	G Glycerine	20 2"	FSL Flangeless Lower	250 1/4 NPT	PSI psi	See Standard
D83LFSS	S Silicone	25 2 1/2"	FSB Flangeless Back		PSI/KPA psi/kPa	Available
		40 4"				Ranges (over)

# Utility Gauge D80 Series

All dimensions are nominal.  
Dimensions in [ ] are in millimeters.

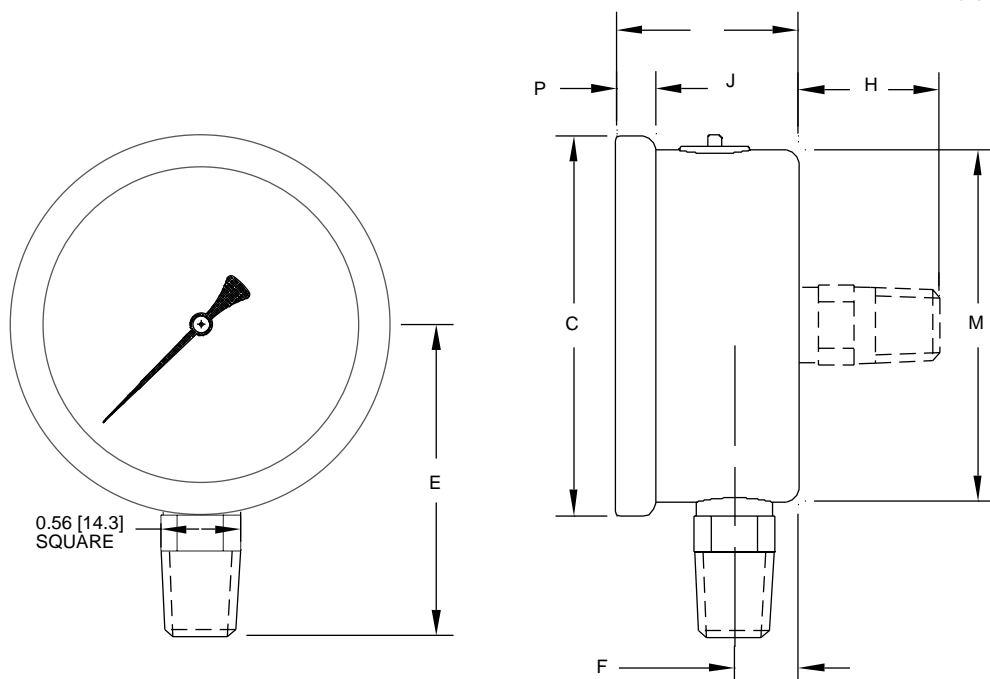

Dial Size	C	E	F	H	J	M	P
2"	2.09 [53.1]	1.91 [48.5]	0.48 [12.2]	0.98 [24.9]	0.93 [23.5]	1.94 [49.3]	0.18 [4.5]
2 1/2"	2.67 [67.8]	2.19 [55.5]	0.45 [11.4]	0.98 [24.9]	0.93 [23.5]	2.47 [62.7]	0.28 [7.1]
4"	4.18 [106.1]	2.85 [72.3]	0.48 [12.2]	1.08 [27.5]	1.04 [26.4]	3.93 [99.7]	0.28 [7.1]

## Standard Available Ranges

### psi Ranges (PSI)

Range Code	Specific Range	Figure Intervals	Minor Divisions
010	30" Hg to 0	5	0.5
020	30" Hg to 15 psi	10/5	1/0.5
030	30" Hg to 30 psi	10/10	2/1
040	30" Hg to 60 psi	30/20	2/2
050	30" Hg to 100 psi	30/20	5/2
060	30" Hg to 150 psi	30/20	10/5
070	30" Hg to 300 psi	30/30	5/10
080	0 to 15 psi	3	0.2
090	0 to 30 psi	5	0.5
100	0 to 60 psi	10	1
110	0 to 100 psi	20	2

## Standard Available Ranges continued

### psi Ranges (PSI)

Range Code	Specific Range	Figure Intervals	Minor Divisions
120	0 to 160 psi	20	2
130	0 to 200 psi	50	5
140	0 to 300 psi	50	5
150	0 to 400 psi	100	10
160	0 to 600 psi	100	10
180	0 to 1000 psi	200	20
190	0 to 1500 psi	300	20
200	0 to 2000 psi	500	50
210	0 to 3000 psi	500	50
220	0 to 5000 psi	1000	100
Ranges over 5000 psi are not available in D82LFB.			
230	0 to 10,000 psi	2000	200
240	0 to 15,000 psi	3000	200

Dual scale (psi/kPa) ranges are available. Specify the range required along with the appropriate Units of Measure code (PSI/KPA).